

Venetian Blind Fitting Instructions

Step 1

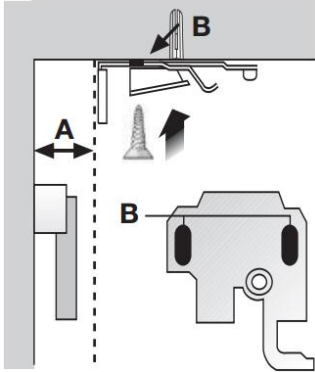

TOP FIXING

Measure the distance that any handles protrude from the frame, **A**. Mark this measurement on the lintel and use it to position the back of the bracket. Mark the position of holes **B** and screw bracket to lintel using screws and rawl plugs supplied.

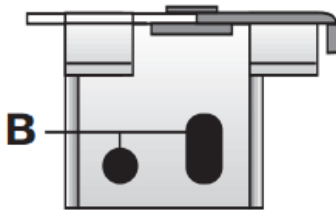

FACE FIXING

Position bracket with swing arm facing towards you, and mark holes **B**. Screw bracket in place. Use rawl plugs if fitting to the wall.

Step 2

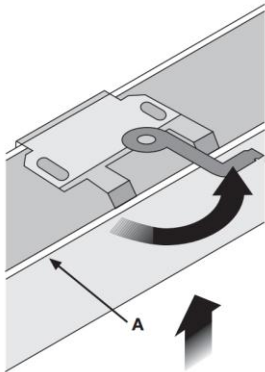

FITTING THE BLIND

Push swing arm anti-clockwise as far as it will go. Now clip the blind over the bracket, first easing the front lip of the headrail **A** in to place.

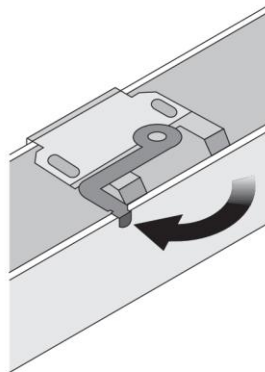

Push swing arm clockwise until it locks in to place, firmly holding the blind headrail.

WARNING

Young children can be strangled by loops in pull cords, chains, tapes and inner cords that operate the product.

To avoid strangulation and entanglement, keep cords out of the reach of young children. Cords may become wrapped around a child's neck. Move beds, cots and furniture away from window covering cords.

Do not tie cords together. Make sure cords do not twist and create a loop.

SAFETY DEVICE

Children can be strangled if a safety device is not installed. Always use a safety device to keep cords or chains out of reach of children.

The safety device must be installed at the maximum distance possible from the control mechanism and at least 1.5m from the floor.

Place the safety device on the wall and mark the positioning of the 2 screw holes.

Wrap the cords around the cleats as shown

When the cords are fully accumulated ensure they are secure so when any cord is pulled ne excess cord is released

