

## QUICK PROGRAMMING FOR TELIS 6 CHRONIS RTS

### DESCRIPTION

The Telis 6 Chronis RTS remote control transmitter allows you to control up to 6 end-products or groups of window coverings using Radio Technology Somfy (RTS). The Telis 6 Chronis can be used in 2 ways: in either MANUAL or AUTOMATIC MODE.

**MANUAL MODE** allows you to control window coverings in the house in groups or individually, depending on their assignments to the 6 groups on the remote control transmitter, called "channels". The channels, numbered 1 to 6, can be customized, by assigning names to each channel.

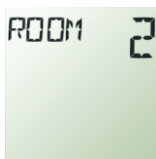

**AUTOMATIC MODE** allows you to control the window covering assigned to the channels on the remote control transmitter automatically, after having created the weekly and daily programs, called "automatic commands". Up to 6 automatic commands can be programmed for each day of the week.



### BEFORE YOU BEGIN

We recommend that each motor is programmed in advance using an individual Telis 1 RTS transmitter and that the limits of each motor are set. However, like any RTS remote control transmitter, the Telis 6 Chronis RTS can be used for motor programming operations (limit switch adjustment, etc.)



After 2 minutes of inactivity, the Telis 6 Chronis RTS screen automatically goes to SLEEP MODE. When the screen is off, first press any button to turn it on. When editing the settings, you can switch between MANUAL MODE or AUTOMATIC MODE at any time by pressing briefly the SELECTION button (○). Only confirmed parameters are saved.



Selection button

## QUICK PROGRAMMING FOR TELIS 6 CHRONIS RTS

### Setting the General Parameters



When the batteries are first installed, REMOTE CONTROL SETTINGS MODE is activated directly: SET and YEAR appear on the screen, with the year flashing (this is the first parameter to be set).

If there is no power supply for an extended period of time (batteries discharged or removed), the general parameters of the remote control transmitter will have to be reset. However, automatic commands remain stored in memory.

**At each stage, the parameter to be set flashes.**

**STEP 1:** Press the ARROW buttons < or > to change the parameter (pressing and holding the button scrolls the characters faster).

**STEP 2:** To save the parameter and move to the next parameter, briefly press the SELECTION button (○),

**STEP 3:** REMOTE CONTROL SETTING MODE can be deactivated at any time by pressing and holding the SELECTION button (○). Only confirmed parameters are saved.

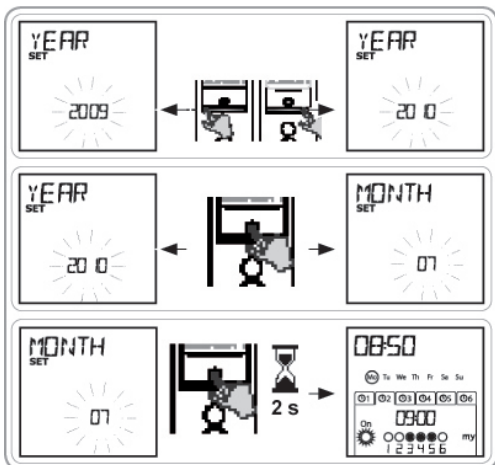

## QUICK PROGRAMMING FOR TELIS 6 CHRONIS RTS

### Set the Following Parameters:

**STEP 1:** YEAR (current year)

**STEP 2:** MONTH (number of the current month)

**STEP 3:** DAY (number of the current day)

**STEP 4/5:** TIME (current time in hours and minutes)

**STEP 6:** AREA ("US/EU" To automatically adjust for Daylight savings)

**STEP 7/8:** JUNE ("Dusk/Twilight time" during midsummer, in hours and minutes)

**STEP 9/10:** DEC ("Dusk/Twilight time" during midwinter, in December, in hours and minutes)



The twilight times must be set between 6 am and 11 pm.

**STEP 11:** Whether or not there are sun sensors on site select SUN (one or more sun sensors) or NO SUN (no sun sensors).

**STEP 12:** Briefly press the SELECTION button (●) to confirm the last parameter. REMOTE CONTROL SETTINGS MODE is deactivated, and the Telis 6 Chronis RTS returns to AUTOMATIC MODE.



REMOTE CONTROL SETTINGS MODE can be deactivated at any time by pressing and holding the SELECTION button. Only confirmed parameters are saved.

1 YEAR SET 20 0	2 MONTH SET 07
3 DAY SET 26	4 TIME SET 08:50
5 TIME SET 08:50	6 AREA SET EU
7 JUNE SET ☾ 08:50	8 JUNE SET ☾ 08:50
9 DEC SET ☾ 8:00	10 DEC SET ☾ 8:00
11 NOSUN SET	12 08:50 Mo Tu We Th Fr Sa Su 01 02 03 04 05 06 On 09:00 my 1 2 3 4 5 6

## QUICK PROGRAMMING FOR TELIS 6 CHRONIS RTS

### Naming a Channel

#### Channels Can Only be Named in MANUAL MODE

**STEP 1:** The Telis 6 Chronis RTS must be in MANUAL MODE (if its in AUTOMATIC MODE, briefly press the SELECTION button (●) to switch to MANUAL MODE).

**STEP 2:** Select the channel you want to customize using the ARROW buttons < or >.

**STEP 3:** Press and hold the SELECTION button (●) until SET appears on the screen SET MODE is activated. The flashing hyphen corresponds to the character to be edited.

**STEP 4:** Select the location of the character to be edited using the navigation buttons < or >. The flashing hyphen corresponds to the character to be edited.

**STEP 5:** Briefly press the SELECTION button (●) to edit the character in this location.

**STEP 6:** The character flashes to select another character, press the ARROW buttons < or >.

 The 5 characters can be alphabetic (A to Z) or numeric (0 to 9)

**STEP 7:** Briefly press the SELECTION button (●) to save the character displayed and move to the next character.

**STEP 8:** Repeat steps 4 to 7 for each of the characters in the channels name.

**STEP 9:** Press and hold the SELECTION (●) button until SET is no longer displayed on the screen SET MODE is deactivated, and the Telis 6 Chronis RTS returns to MANUAL MODE.



Naming Other Channels:  
Repeat steps 1 to 9 for each  
channel you want  
to customize.

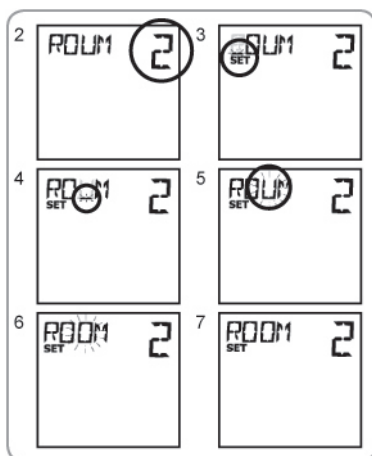

## QUICK PROGRAMMING FOR TELIS 6 CHRONIS RTS

### Adding or Deleting Transmitter/Channel



The procedure for assigning window coverings to the channels of the Telis 6 Chronis RTS and deleting them is identical. It can only be done in MANUAL MODE.

**STEP 1:** Make sure that the Telis 6 Chronis RTS is in MANUAL MODE (if it is in AUTOMATIC MODE, briefly press the SELECTION button (●) to switch to MANUAL MODE).

**STEP 2:** Press and hold the PROGRAMMING BUTTON on the individual RTS transmitter already in memory until the window covering jogs.

**STEP 3:** Use the ARROW buttons < or > to select the channel on the Telis 6 Chronis RTS to be programmed.

**STEP 4:** Briefly press the PROGRAMMING BUTTON on the Telis 6 Chronis RTS: the window covering jogs and it is assigned to or deleted from the chosen channel on the Telis 6 Chronis RTS.



In order to assign or delete the window covering from other channels, repeat steps 1 to 4, selecting another channel. To assign or delete other window coverings, repeat steps 1 to 4.

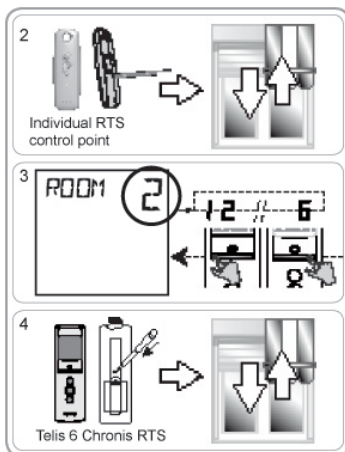

## QUICK PROGRAMMING FOR TELIS 6 CHRONIS RTS

### TILT MODE

If the window coverings has tiltable slats (interior or exterior Venetian blinds, roller shutters with tiltable slats), SLAT ORIENTATION MODE can be configuration in EU or US MODE on each channel. For the motors of interior blinds, other than blinds with tiltable slats: blinds, roller shutters, screens, etc. it is recommended that the TILT MODE be configured in US MODE. BY default, all channels are configured in US MODE.



TILT MODE can only be changed in MANUAL MODE

**STEP 1:** Make sure that the Telis 6 Chronis RTS is in MANUAL MODE (if it is in AUTOMATIC MODE, briefly press the SELECTION button (○) to switch to MANUAL MODE)

**STEP 2:** Select the channel you want to configure using the ARROW button < or >.

**STEP 3:** Press and hold the SELECTION button (○) until SET and MODE appears on the screen: US or EU flashes. To change MODE, press the ARROW button < or >.

**STEP 4:** Briefly press the SELECTION button (○) to save the parameter and exit TILT MODE.



To configure another channel, repeat steps 1 to 5.

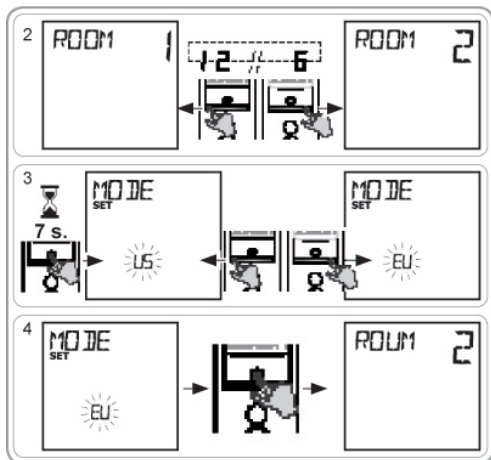

## QUICK PROGRAMMING FOR TELIS 6 CHRONIS RTS

### Programming the days of the week

The Telis 6 Chronis can automatically send orders to one or more groups of window coverings when it is in AUTOMATIC MODE, after creating a program. Up to 6 automatic commands any combination of the 6 can be programmed for each day of the week.

#### Each of these Automatic Orders can be:

1. Set for a specific set time or a twilight/dusk
2. Applied to 1 to 6 channels (all window coverings on the same channel are controlled at the same time) , , ,  (on),  (off), chosen commands.



The days of the week can only be programmed in AUTOMATIC MODE. AUTOMATIC COMMAND PROGRAMMING MODE can be deactivated at any time by pressing and holding the SELECTION button (○). Only confirmed parameters are saved.

### Selecting the Day to Be Programmed

**STEP 1:** Make sure that the Telis 6 Chronis RTS is in AUTOMATIC MODE (if it is in MANUAL MODE, briefly press the SELECTION button (○) to switch to AUTOMATIC MODE).

**STEP 2:** Press and hold the SELECTION button (○) until SET appears on the screen: AUTOMATIC COMMAND PROGRAMMING MODE is activated, and the day previously displayed flashes.

**STEP 3:** Select the day you want to program using the ARROW buttons < or > .

**STEP 4:** Briefly press the SELECTION button (○) to program the day that is flashing: EDIT appears and flashes

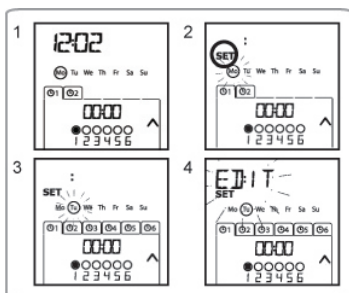

## QUICK PROGRAMMING FOR TELIS 6 CHRONIS RTS

### Editing an Automatic Order

**STEP 5:** When EDIT flashes, briefly press the SELECTION button (○) and AUTOMATIC ORDER flashes.

### Creating or Modifying an AUTOMATIC ORDER

**STEP 6:** To create a new AUTOMATIC ORDER: select the blank order using the ARROW buttons < or > and go to step 7. (If 6 automatic orders have already been created, only one of these orders can be modified).

-To modify an automatic command: select the "automatic command" to be modified using the ARROW buttons < or > and go to SELECTING THE TIME.

### Selecting the Time

**STEP 7:** Briefly press the SELECTION button (○) to confirm the selection: the time flashes.

**STEP 8:** Use the ARROW buttons < or > , to select the twilight option or at a set time and briefly press the SELECTION button (○) to confirm the selection. To edit a twilight time, go to SELECTING THE CHANNELS. To edit a set time, go to next step.

**STEP 9:** The hour flashes: to change the hour, press the ARROW buttons < or >.

**STEP 10:** Briefly press the SELECTION button (○) to confirm the hour and then set the minutes.

**STEP 11:** The minutes flash: to change the minutes, press the arrow buttons < or >.

**STEP 12:** Briefly press the SELECTION button (○) to confirm the time and then set the channels.

### Selecting the Channels

**STEP 13:** Select the channel to be activated using the ARROW buttons < or > then briefly press the SELECTION button (○) to activate (symbol ●) or deactivate (symbol ○) the channel (to respond to timed commands).

**STEP 14:** Press the ARROW buttons < or > to select another channel and repeat "STEP 13" to activate or deactivate each channel.

**STEP 15:** Once the channels have been selected, press the ARROW buttons < or > until all 6 channels flash simultaneously.

**STEP 16:** Briefly press the SELECTION button (○) to confirm the channel selection and then set the command.

### Selecting the Command to be Sent

**STEP 17:** An order flashes: to select an command from (⬆), (my), (⬇), (⚙️)(on), (⚙️)(off) press the ARROW buttons < or > .



The ⚙️ (on) and ⚙️ (off) orders are not displayed when programming the days of the week if NO SUN (no sun sensors) was selected when the general parameters of the timer were set.



## QUICK PROGRAMMING FOR TELIS 6 CHRONIS RTS

**STEP 18:** Briefly press the SELECTION button (●) to confirm the order selected: the day concerned flashes.

**STEP 19:** Press and hold the SELECTION button (●) to exit SET MODE and return to AUTOMATIC MODE.

- To modify another AUTOMATIC COMMAND, repeat the procedure starting at STEP 1.
- To program ANOTHER DAY, repeat the procedure starting at STEP 1
- To copy the program for one day and assign it to another day, see the COPYING THE PROGRAM FROM ONE DAY TO ANOTHER
- To delete an automatic order, see the DELETING THE AUTOMATIC COMMAND section.

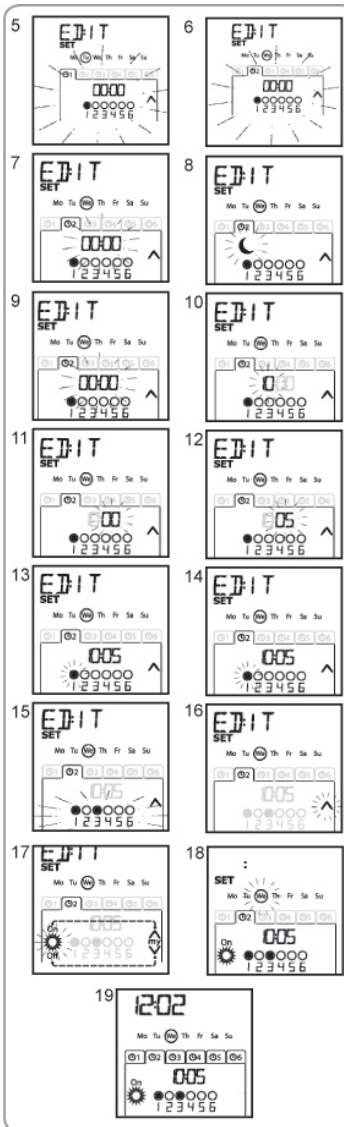

## QUICK PROGRAMMING FOR TELIS 6 CHRONIS RTS

### Copying the Program from One Day to Another

When the program for one particular day is identical to that of another day of the week, the copy/paste function can be used to copy the entire program that has already been configured for one day and paste it to another day.

**STEP 1:** Make sure that the Telis 6 Chronis RTS is in AUTOMATIC MODE (if is in MANUAL MODE, briefly press the SELECTION button (●) to switch to AUTOMATIC MODE.

**STEP 2:** Press and hold the SELECTION button (●) until "SET" appears on the screen: AUTOMATIC COMMAND PROGRAMMING MODE is activated, and the day previously displayed flashes.

**STEP 3:** Select the day you want to copy using the ARROW buttons < or >.

**STEP 4:** When the day to be copied flashes briefly, press the 2 ARROW buttons < and > simultaneously: COPY appears.

**STEP 5:** Select the day to which the program is to be copied using the ARROW buttons < or >.

**STEP 6:** Press both arrow buttons < and > simultaneously: "PASTE" appears, the program that was copied is pasted onto this other day.

**STEP 7:** Press and hold the SELECTION button (●) to exit SET MODE and return to AUTOMATIC MODE.

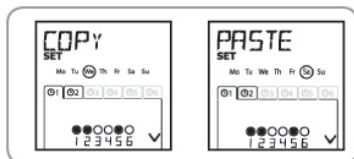

## QUICK PROGRAMMING FOR TELIS 6 CHRONIS RTS

### Deleting an Automatic Command

**STEP 1:** Make sure that the Telis 6 Chronis RTS is in AUTOMATIC MODE (if it is in MANUAL MODE, briefly press the SELECTION button (○) to switch to AUTOMATIC MODE).

**STEP 2:** Press and hold the SELECTION button until "SET" appears on the screen: AUTOMATIC COMMAND PROGRAMMING MODE is activated, and the day previously displayed flashes.

**STEP 3:** Select the day you want to modify using the ARROW buttons < or > .

**STEP 4:** Briefly press the SELECTION button (○) to modify the program of the day that is flashing: "EDIT" appears and flashes.

**STEP 5:** Press one of the ARROW buttons < or > to change menu: "DELETE" (delete) flashes.

**STEP 6:** Briefly press the SELECTION button (○) to confirm: an automatic order flashes.

**STEP 7:** Using the ARROW buttons < or > select the automatic command to be deleted and briefly press the SELECTION button (○) to delete the automatic command that is flashing: the automatic command is deleted.

**STEP 8:** Press and hold the SELECTION button (○) to exit "SET" mode and return to AUTOMATIC MODE.

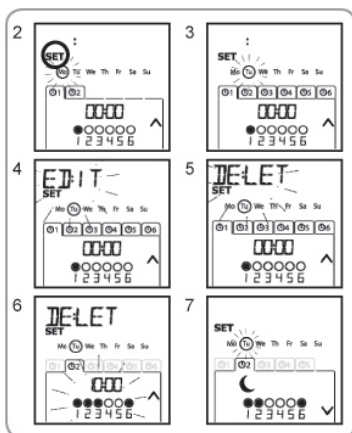

## QUICK PROGRAMMING FOR TELIS 6 CHRONIS RTS

### OPERATION IN USER MODE



To switch from MANUAL to AUTOMATIC MODE, or AUTOMATIC to MANUAL MODE, briefly press the SELECTION button (○).



### MANUAL MODE

**MANUAL MODE** on the Telis 6 Chronis RTS is used to:

- Send an occasional order to the window coverings assigned to the 6 different channels
- Deactivate automatic command programming. For example, Channel 1 "ROOM" is used to open the shades of the parents bedroom, Channel 2 "LIVIN" is used to move the shades in the livingroom to the ideal position to avoid glare on the computer and TV screens, and Channel 3 "Patio" is used to lower the awning to go and sit outside, etc.



When MANUAL MODE is selected, the sun function is automatically deactivated. The function will be reactivated at the next programmed ⚙️ (Sun on) automatic command.

### Controlling the Channels Manually

**STEP 1:** Select the channel of the Telis 6 Chronis RTS to be used with the ARROW buttons < or > : each channel is identified by a number and the selected name (see "Naming of channels" section).

**STEP 2:** Briefly press the ▲, my, ▼ or a button corresponding to the desired command.

**STEP 3:** When the intermediate position has been programmed and the window covering is stopped, briefly press my (STOP): the window covering or the group of window coverings is activated and goes to the "MY" (STOP) favourite position.

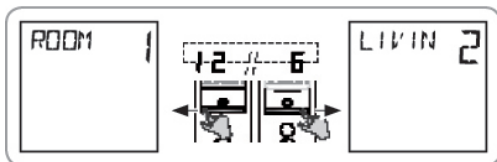

## QUICK PROGRAMMING FOR TELIS 6 CHRONIS RTS

### AUTOMATIC MODE

AUTOMATIC MODE on the Telis 6 Chronis RTS is used to:

- Automatically control the window coverings assigned to the 6 different channels, using automatic commands programmed according to the days of the week.
- Program the activation or deactivation of the SUN function, according to the channels.
- Programming the automatic orders for each day of the week (see Programming the days of the week section).
- In AUTOMATIC MODE, the current day and the next automatic command scheduled for that day are displayed.
- To view all automatic orders that have been programmed, scroll from one to the other using the ARROW button < or >.
- To stop an automatic order that is in progress, return to MANUAL MODE by briefly pressing the SELECTION button (○), select the channel corresponding to the window coverings concerned and press the  (STOP) button.

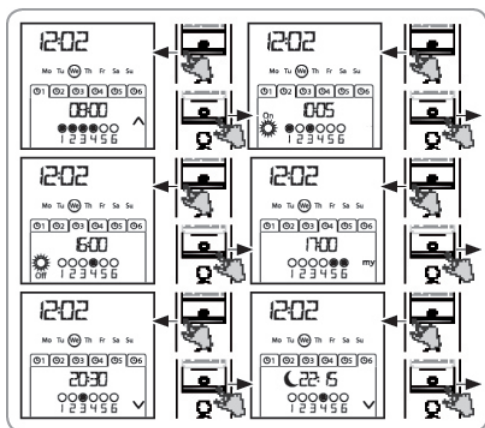

## QUICK PROGRAMMING FOR TELIS 6 CHRONIS RTS

### VACATION MODE

In AUTOMATIC MODE, the "VACATION MODE" function randomly changes the times at which the programmed automatic commands are sent, within a range of 0 to 30 minutes. This function is specially recommended to simulate your presence when you are away from home for an extended period of time.

#### To Activate the Function:

**STEP 1:** Make sure the Telis 6 Chronis RTS is in AUTOMATIC MODE (if it is in MANUAL MODE, briefly press the SELECTION button (○) to switch to AUTOMATIC MODE).

**STEP 2:** Press both ARROW buttons < and > simultaneously: the (🔒) symbol appears on the screen: the VACATION MODE function is activated.

#### To Deactivate the Function:

Press both ARROW buttons < and > simultaneously: the (🔒) symbol disappears from the screen: the VACATION MODE function is deactivated.

OR switch to MANUAL MODE

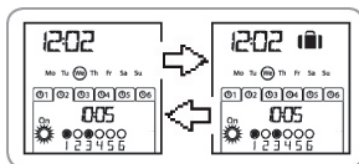

## QUICK PROGRAMMING FOR TELIS 6 CHRONIS RTS

### MANUAL MODE

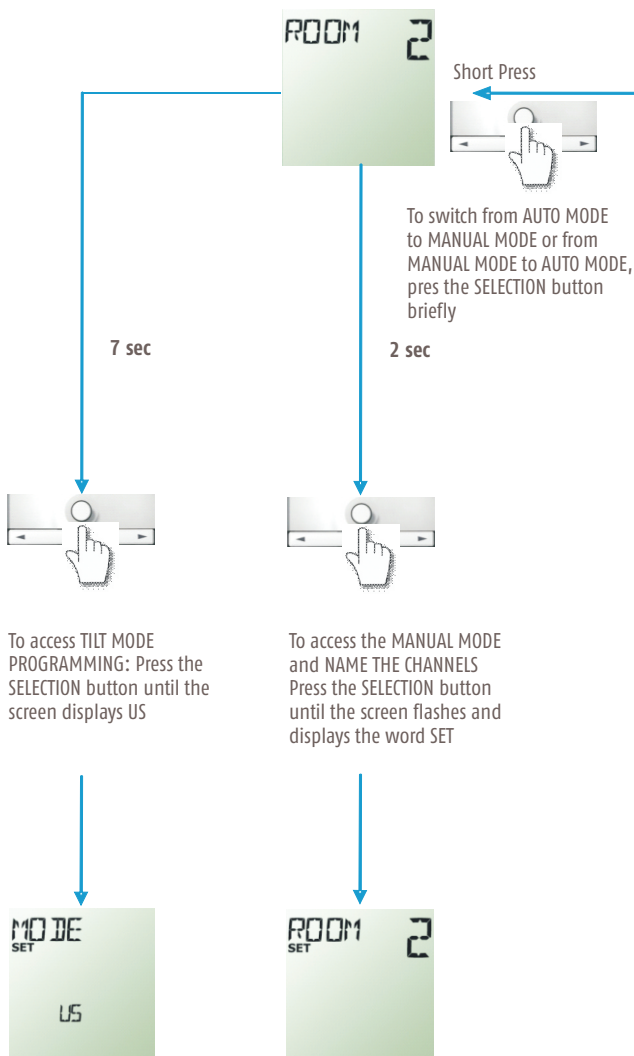

## AUTOMATIC MODE

Short Press



To switch from AUTO MODE to MANUAL MODE or from MANUAL MODE to AUTO MODE, press the SELECTION button briefly

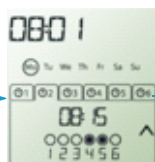

2 sec



To access the AUTO MODE and SET TIMES RANGES Press the SELECTION button until the screen flashes and displays the word SET

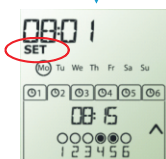

7 sec



To access the GENERAL MODE and SET THE GENERAL PARAMETERS Press the SELECTION button until the screen displays YEAR.

