

24.7blinds

## FITTING GUIDE

# Clip Fit



**Fitting Time:** Approx. 5 mins

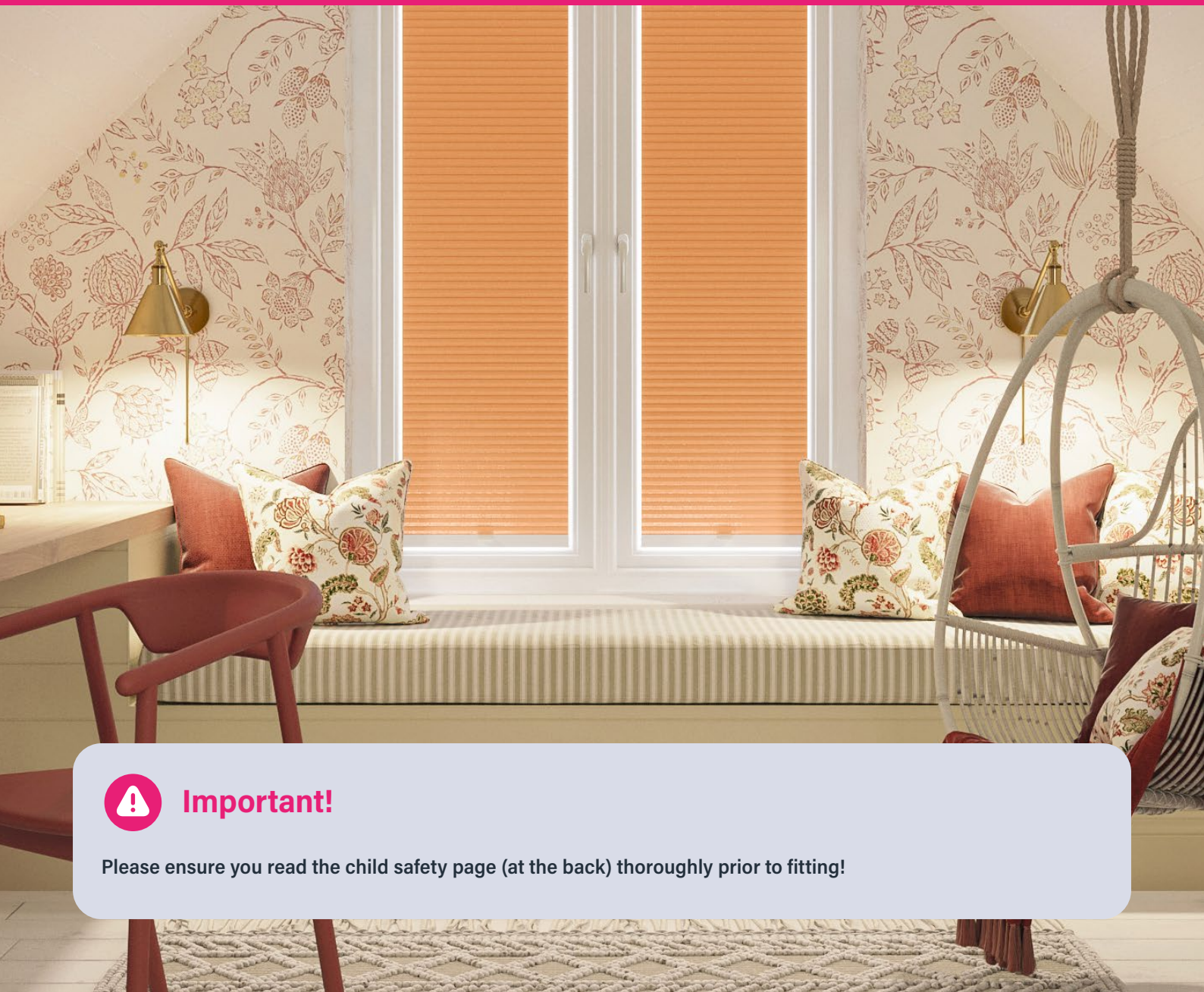

### Important!

Please ensure you read the child safety page (at the back) thoroughly prior to fitting!

## Step 1 - Fitting the brackets

Push the bracket in as far as possible. Do the same with the three other brackets in the other corners of the glass, as shown in the diagram. If you face some difficulty, prep the bracket holes with a knife and/or use lubricant such as washing up liquid to help slide the brackets underneath.

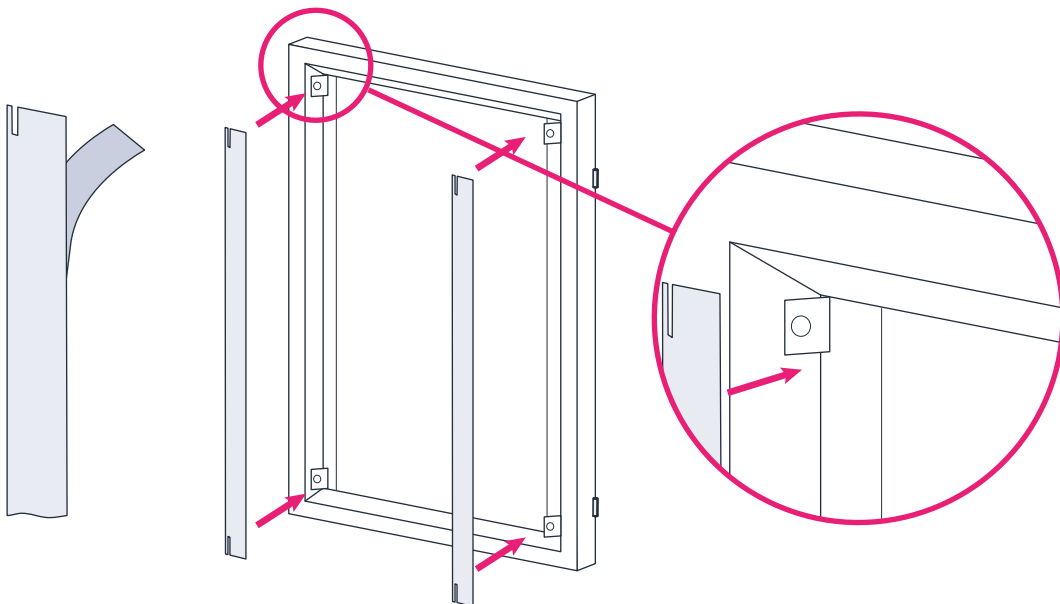
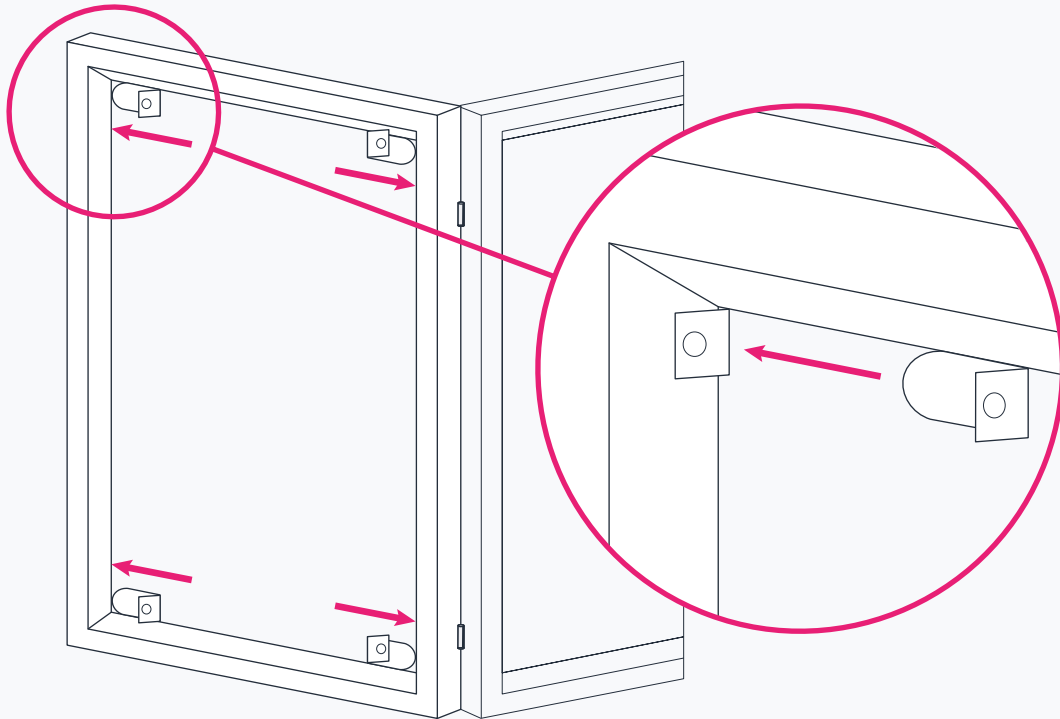

## Step 2 - Applying the side profiles

First ensure that the strips and brackets are in the correct position to mount the blind. You may need to slightly adjust the brackets in/out to ensure a snug fit & ensure the strips correctly line-up.

Second, remove the backing paper from the self-adhesive strips. Place the strip so that the cut outs go either side of the brackets, with the cut-out part closest to the window frame.

### Step 3 - Installing the blinds

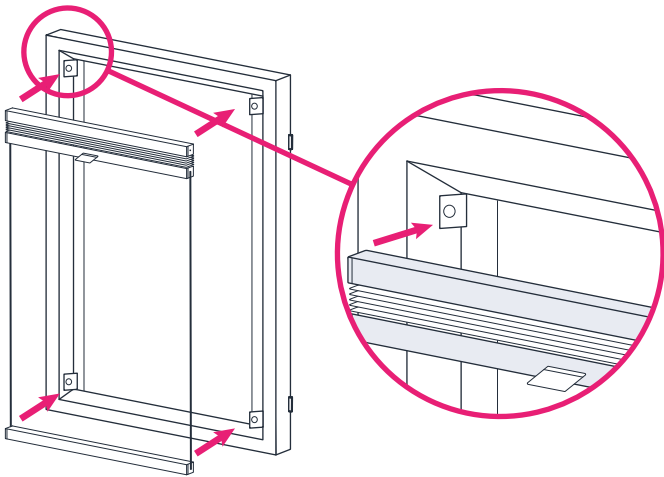

Locate the slot on the back of the left and right side of the headrail onto the exposed brackets

Gently push first the headrail and then the bottom rail onto the exposed bracket.

Ensure the raised circle on the exposed bracket locates into the hole on the plastic head and bottom rail end caps.

The cord tension can be adjusted using the small spring inside the bottom rail.

### Step 4 - Operating the blinds

To raise and lower the blinds simply pull up and down using the handle.

The clever, fold away handle makes it ideal to use on bi-fold doors where it is important that the blind does not protrude further than the window frame.

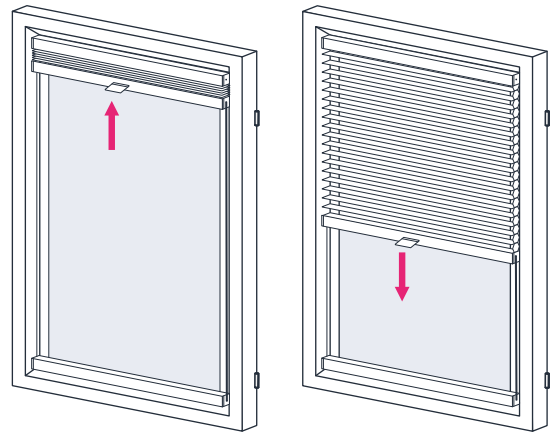

#### For Venetian Clip Fit blinds only

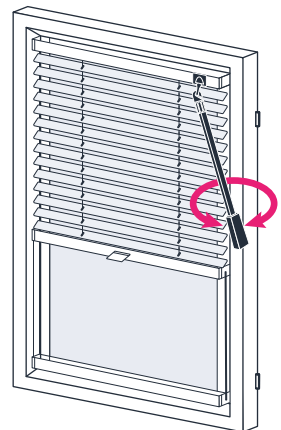
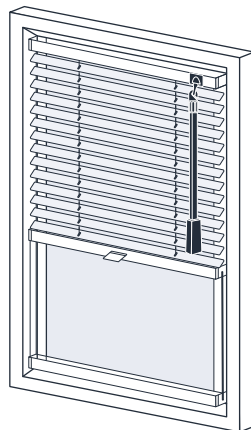
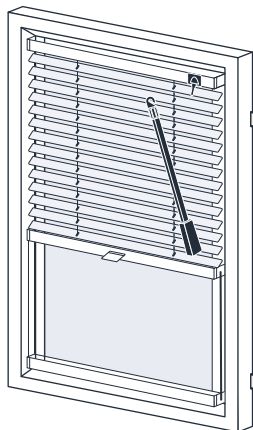

Attach the plastic wand by hooking the wand onto the tilt mechanism on the venetian blind.

Simply twist the wand to open and close the slats.

# Child Safety



## WARNING

Ensure that all provided safety mechanisms accompanying the blind are properly and securely installed to mitigate potential risks.

It is imperative to ensure that all cords remain inaccessible to children, those at risk, and pets. Due to their cords and chains, blinds can pose a potential strangulation hazard.

Relocate any adjacent beds, cots, and furniture that may be scaled, ensuring they are positioned at a safe distance from windows. Under no circumstances should cords be tied together. It's vital to prevent the cords from becoming entangled or forming loops.

For Venetian Blinds, a safety feature in the form of a breakaway wand is included.

