

247blinds

TWIST & FIT

# PLANTATION SHUTTER

FITTING GUIDE



Fitting Time: Approx. 5 Min



**WARNING:** PLEASE READ THE INSTRUCTIONS BEFORE OPERATING THIS PRODUCT



## WHAT YOU'LL NEED

Screwdriver



Measuring tape

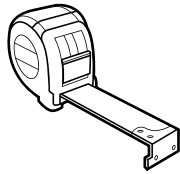

Pencil



**Recommended extras:** Spirit level, decorators caulk and packing material such as cardboard or wedges.

## WHAT'S IN THE BOX

Shutter panels in rectangular boxes\*

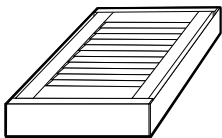

Frames in a separate, longer box\*

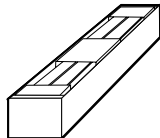

Screws

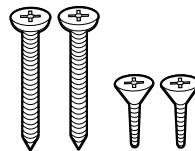

Hinges

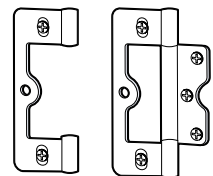

Hinge Packers

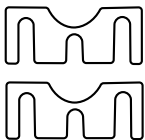

Hinges pins

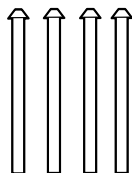

Plastic Hoffman Keys

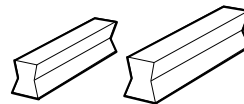

Small Drill Cover Caps

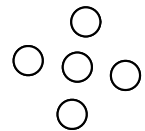

Pre-installed  
Twist&Fit Screws



247 2mm Allen Key

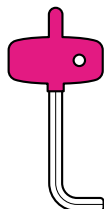

\*Where possible to avoid transit damage, we try to streamline packaging, this could mean, where the shutter is small enough, for example a 1-panel size, that you only receive the one box. Open it up and layout your pieces, and if you're worried you've not received the full kit; give us a call on 01484 443790.

THE INSTALLATION OF THIS PRODUCT SHOULD BE  
CONDUCTED BY SOMEONE COMPETENT IN DIY.

Carefully open the packaging and lay out the contents on the floor.

Please note that drill holes are not always pre-drilled into the frames, this is to allow you to fit the blinds as you require.

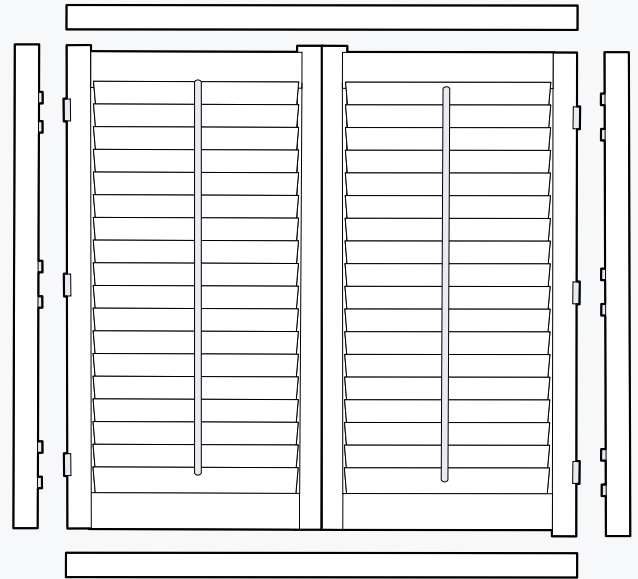

## STEP 1 - ASSEMBLING THE FRAME

After laying out your frame, panels and pieces, position these up to ensure everything slots into the right place.

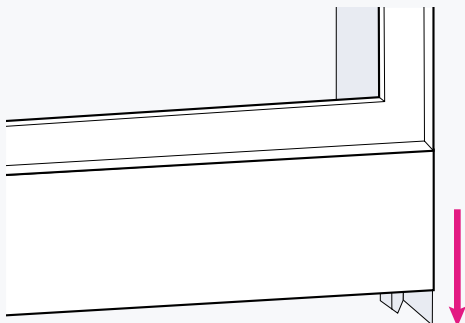
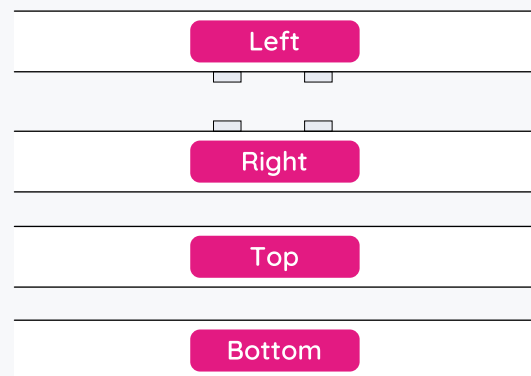

Slide your frame pieces together. The end of the frames are mitred (cut at an angle to pair with another piece), designed to connect to the adjoining piece.

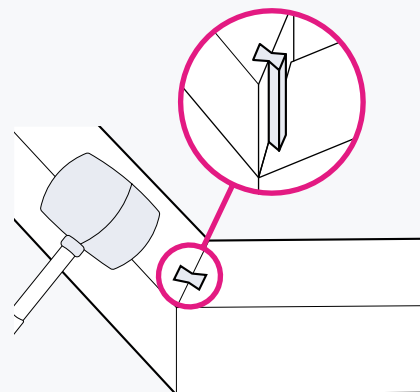

Check the back of your frame, a bowtie-shaped hole forms in each corner. You should use the plastic Hoffman key and tap this into the holes to connect the frames. Do not use another frame piece to tap this in, something like a rubber mallet is more suitable.

## FOR TIER ON TIER ONLY

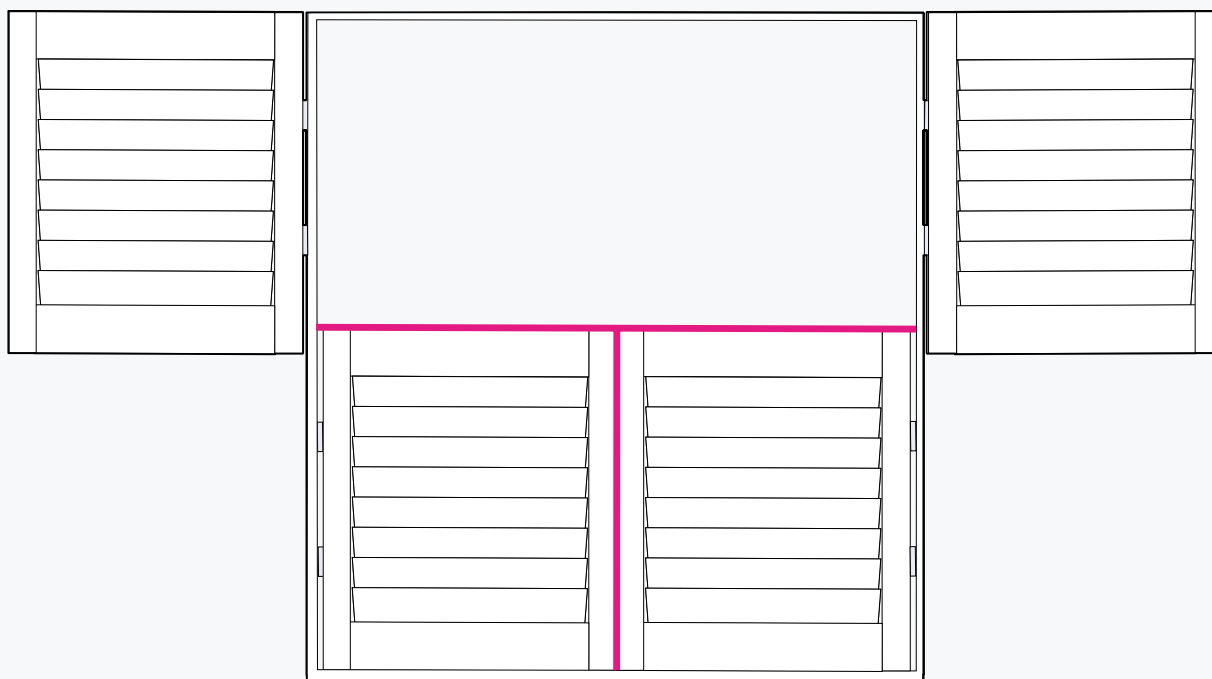

We ask that you provide us with the divide height of your Tier-on-Tier shutter, as this determines where your shutter panels split into two tiers.

**For shutters under 1500mm in width**, the door panels have small stoppers on the top and bottom, ensuring a snug fit.

**For shutters over 1500mm in width**, a supportive horizontal T-Bar is supplied. This is approximately 50mm as standard and comes as one piece, as we do not offer this as a configurable option.

**NOTE:** For Bromley Snow & True White, shutters come with a T-Bar by default, regardless of width. Insert the T-Bar into the frame using the pre-drilled holes. Once assembled, lift the frame into position.

This is where a spirit level becomes useful, use packing as you go along as required.

## STEP 2 - FITTING THE FRAME

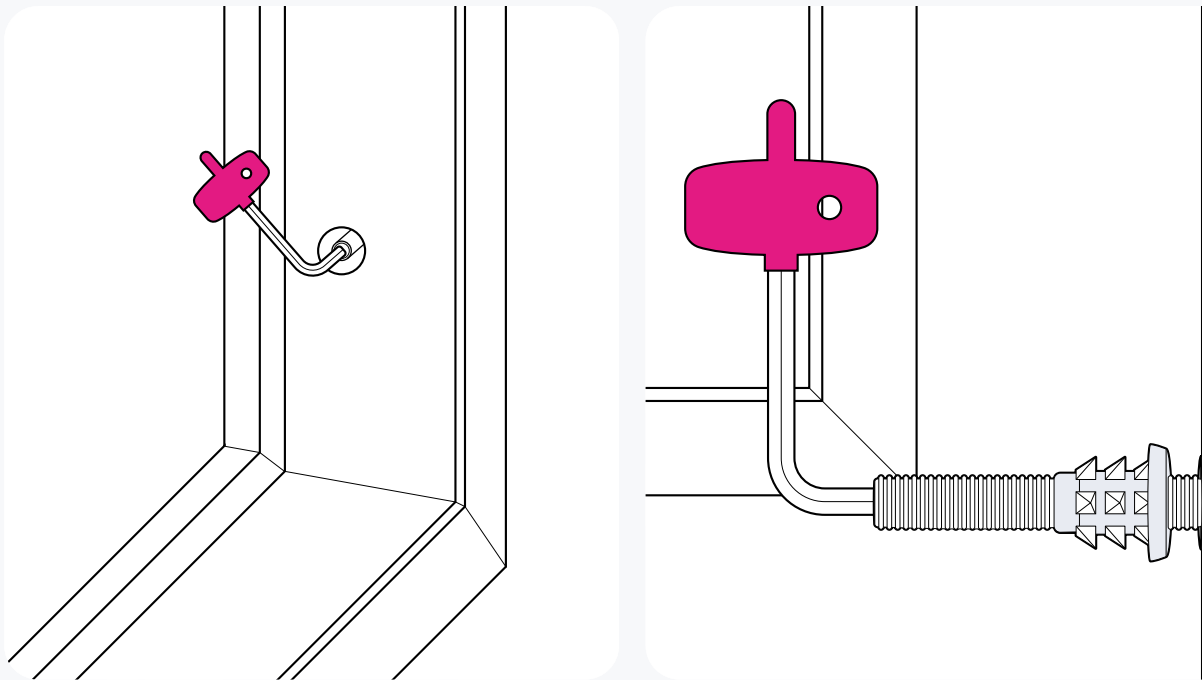

Once you've assembled the shutter frame using the Hoffman key, lift it into the recess and slide it into position. Place a spirit level on the bottom edge and adjust the frame until it's level. It can help to have someone hold it steady while you do this.

If the frame feels loose or moves around, place small pieces of cardboard between the frame and the wall to hold it snugly in place.

Using the 247 2mm Allen key, locate the screw holes on the underside of the top and bottom sections. Gently tighten the screws, working around the frame and gradually increasing the tension. Keep checking that the frame stays straight as you go and leave a bit of slackness for the straightening of the door panels in the next step.

**NOTE:** Brackets are pre-fitted onto the frame for you. If you require, you can lightly unscrew these and slide the brackets up or down to adjust. Do not use all the screws, or drill the frame in fully at this point.

Ensure that your panels are the right way up, either by checking the tilt rod can slot into the mouse hole at the top of the slats at the front, or by ensuring that the slats close upwards.

If instead you've chosen the hidden rod option, there will always be a rebate in the top rail to accommodate the closed slat.

## STEP 3 - FITTING THE PANELS

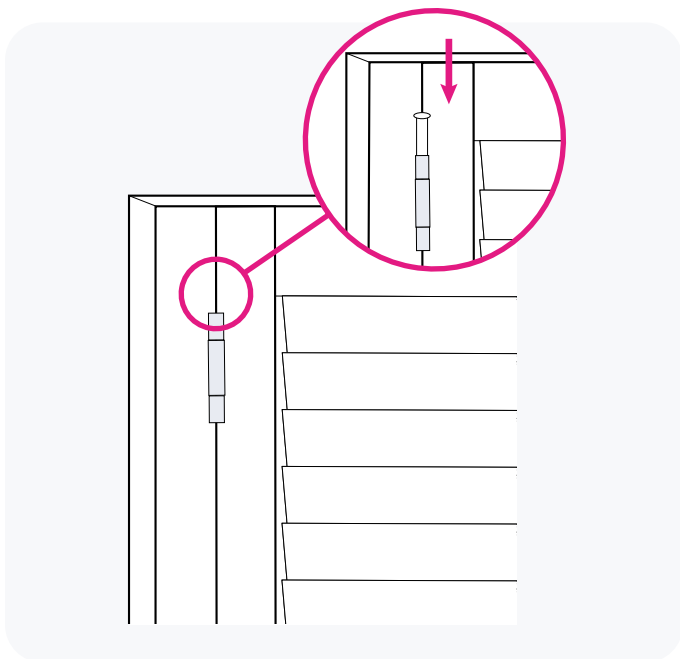

Lift your 1st panel into the frame, then secure by sliding the hinge pin in each hinge. Repeat on the other panels.

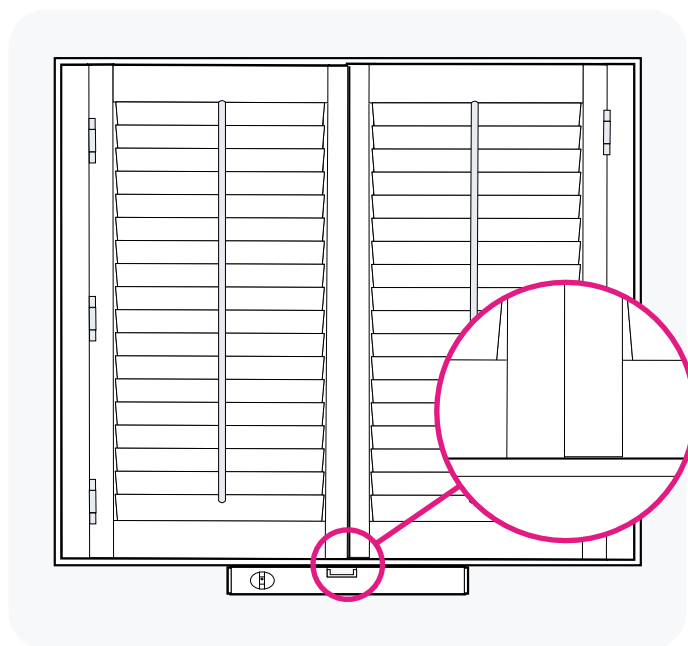

Once done, close the panels and lightly shift the frame left to right until all of the panels line up together at the top. Use a spirit level to check.

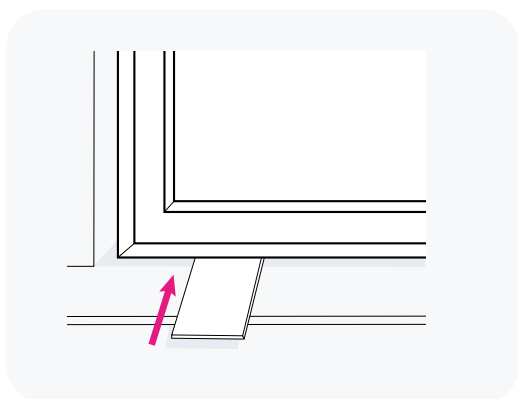

Carefully unhinge the panel doors and take the panels down. Tension up the Twist&Fit screws so the frame is fully secure.

Replace the panels as before, securing with the hinge pins. Should you need to, use the hinge packers supplied to make fine adjustments to the space between the closed panels. You can also adjust the panels position vertically.

Now fully secure your hinges by tightening the screws and putting the final middle locking hinge screw in.

For a clean finish, place caps into the holes onto the frame.

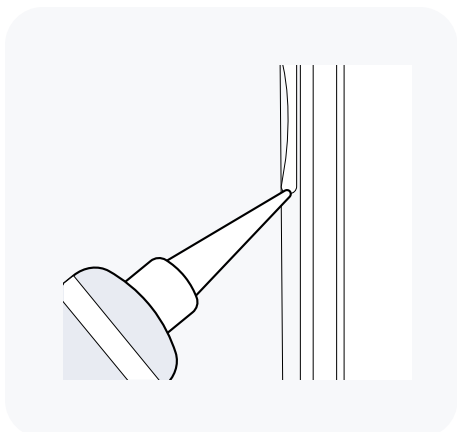

Using your decorators caulk, seal any gaps around the frame. You may also want to caulk the inside of the back of the frame. Afterwards, use a wet wipe to finish.

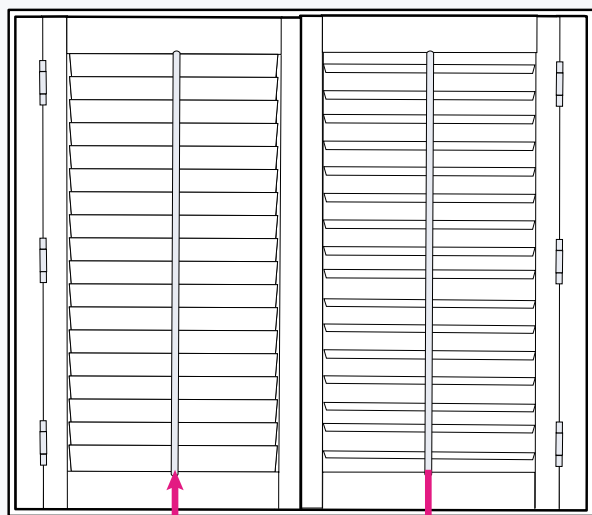

Vanes Closed

Vanes Open

To close the vanes, push the tilt rod upwards. Then, applying light pressure, run your hand upwards from the bottom to fully close them. When closing the panels, support the weight of the leading door, lift up slightly and place back into the frame.

You may find over time that your slats lose some tension. Not to worry, this can be adjusted by using the slat tension screws, which are located on the inside edge of the panels. A quarter turn of the screw is enough to tighten the mechanism.



## WARNING

Do not use the tilt rod to open and close the shutters. Use this only to open and close the vanes. When closing, support the weight of the leading door, lift up slightly and place back into the frame.

For further help and advice please call:  
01484 443790

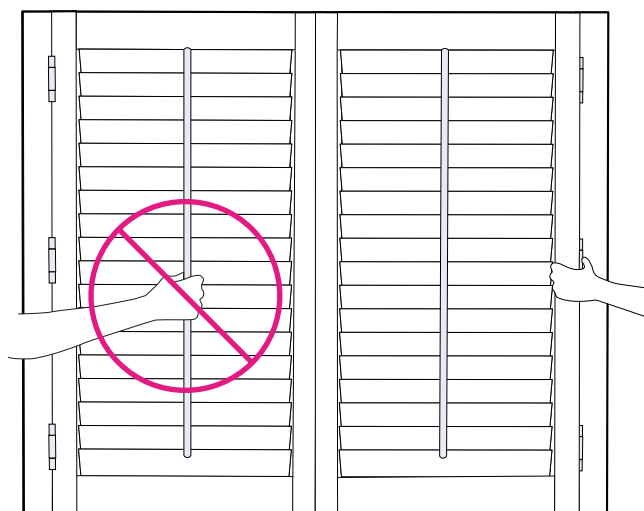

# CHILD SAFETY

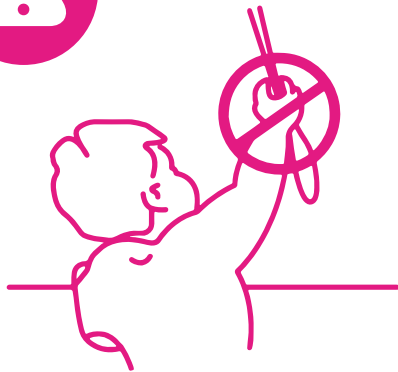

## WARNING

Whilst Plantation Shutters are child safe by design, as with all window dressings they still pose a risk if used unsafely or installed in an unsafe location.

To ensure your shutter is as safe as possible please ensure all beds, cots or furniture that can be climbed is moved away from the window.

While the shutters do pose minimal risk in regards to choking or strangulation the panels can still be pulled off the hinges and cause a risk of crushing or injury.