

Motorised Wooden & Faux Wood Blind Fitting Instructions (Tilt & Lift)

Fitting The Blind:

Step 1 - Fitting the brackets

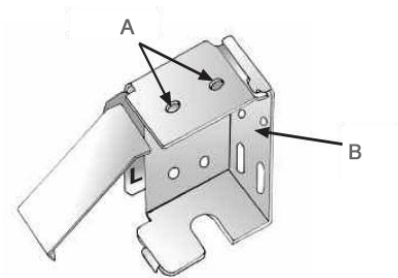

Extend hinged door on each bracket as far as it will go. Identify left and right brackets from L and R markings inside. Position the bracket and mark two holes according to type of fixing chosen (A – Top Fix, B – Face Fix)

Step 2 - Fitting the blind

Note: You will need at least 40mm clearance behind the headrail to fit the battery pack in the ideal position.



Once the brackets are fitted, remove plastic end caps from blind headrail. Slide the blind into the brackets, with velcro patches facing towards you.



Push down and snap shut the hinge doors to lock the headrail into position.

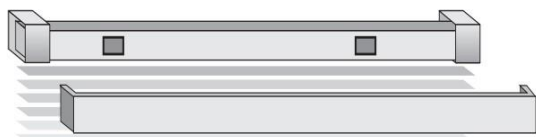

Remove the thin plastic backing from both velcro patches, leaving adhesive surfaces. Position fascia on front and press firmly to adhere. If supplied, wooden returns will fit automatically into place at ends of headrail.

A Quick Note About Re-Charging Your Blind:

To re-charge your motorised roller simply connect your Somfy charger into the port in the end of the battery. Please note that you may need to remove your battery pack from its place in order for the charger to reach it.

Fitting Your Li-Ion Battery Pack:

Step 1 - Fitting The Battery Pack

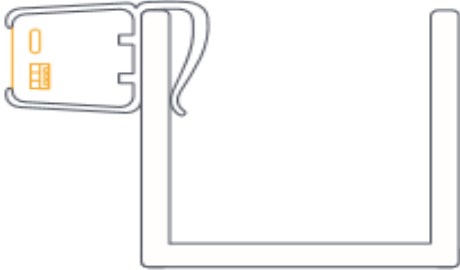

There are 2 options for fitting the battery pack:

Use the clips to attach the battery pack to the back of the headrail.

OR

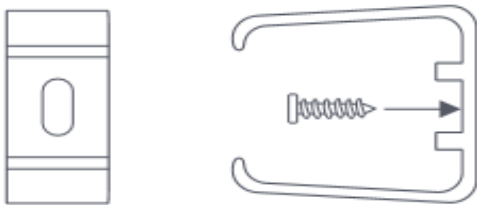

Attach the wall brackets to desired area in your window recess, leaving enough room for the blind.

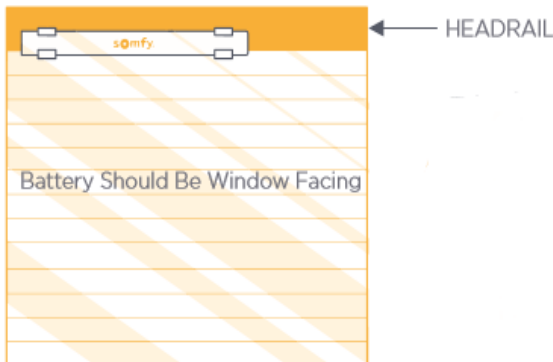

The battery pack can be secured outside the headrail in either a vertical or horizontal position.

We recommend the battery pack is secured behind the headrail so it is hidden from view.

Note: You will need at least 40mm clearance behind the headrail to fit the battery pack.

Step 2 - Connecting the Battery Pack

Connect the battery pack to the motor by simply connecting the battery cable to the motor cable.

Make sure that the antenna is not obscured or tangled up.

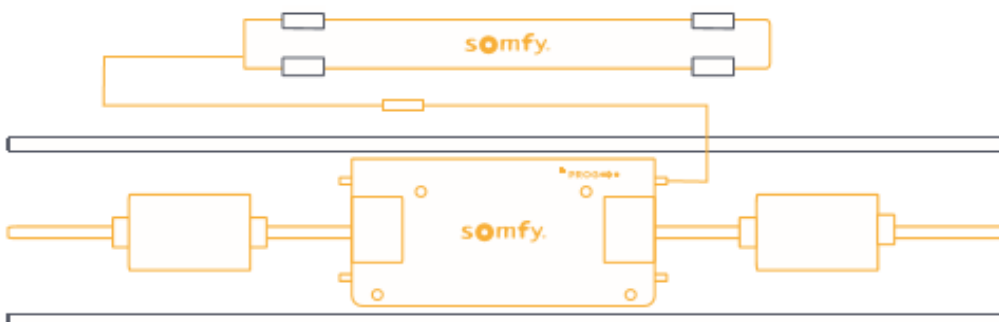
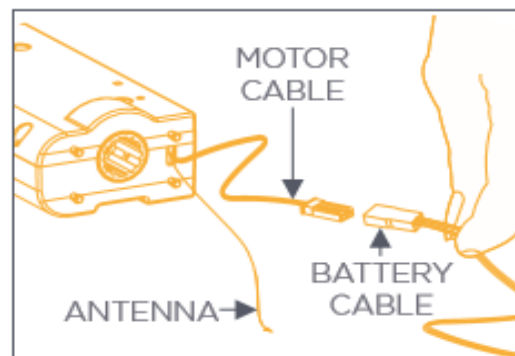

Programming Your Remote:

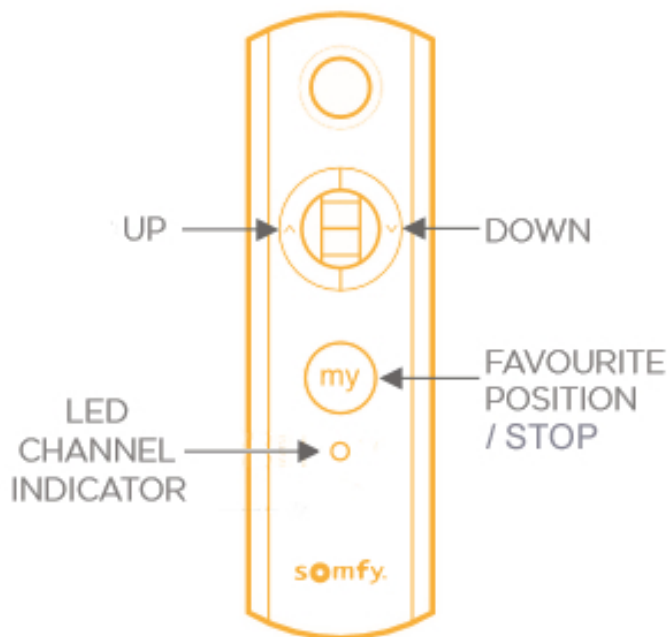

Telis 1 Modulis

Note: Your remote should come pre-paired with the blind that it belongs to. If not, please follow the quick and easy step below to pair it.

Pairing A Remote With A Motor:

On the remote, press and hold the UP and DOWN buttons simultaneously until the blind jogs.

Power should only be connected to the blind/blinds being programmed. All other blinds should be disconnected from their respective power while programming is in progress.

Pairing A Second Remote:

1. Using a paper clip or pen, press and hold the PROGRAM button on the back of the original remote until the blind jogs once.
2. Using a paper clip or pen, press and hold the PROGRAM button on the new remote until the blind jogs once. New remote is now added to the memory and can be used to operate the blind.

Note: Power should only be connected to the blind/blinds being programmed. All other blinds should be disconnected from their respective power while programming is in progress.

Setting Your Favourite Position (MY button):

1. Press the UP or DOWN button until the blind reaches a desired favourite position, then press the MY (Stop) button to stop.
2. Press and hold the MY (Stop) button until the blind jogs. Favourite MY slat position is now added to the memory.
3. Activate the blind favourite position by pressing the MY (Stop) button from any position. The blind will move to the closed DOWN position prior to stopping at the programmed MY position.

Operating Your Blind:

* For setting your 'Favourite Position' (MY button), please see page 3.

Tilt Operating:

Tilting The Slats Up:

Scroll over the dial in an upwards motion until the desired slat position is reached.

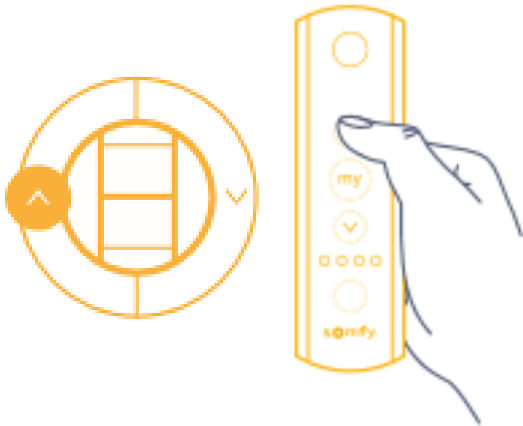

Tilting The Slats Down:

Scroll over the dial in a downwards motion until the desired slat position is reached.

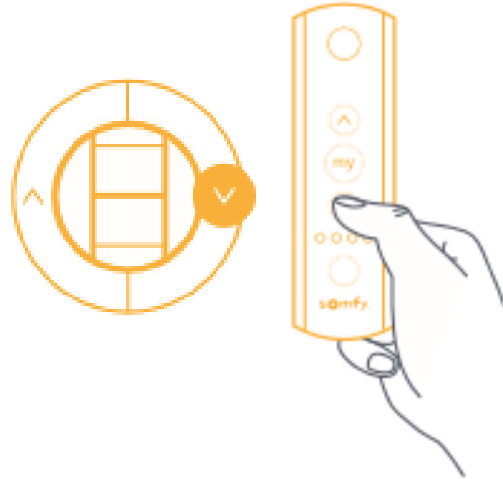

Note: The slats will operate at 1/2 speed. If you press momentarily on the Up or Down button, the slats will move to the pre-programmed limit (slat position) at full speed (see page 6 for how to change speed).

Raise/Lower Operating:

Raising The Blind Up:

1. Press the UP button to lift the blind.
2. Press the MY button to stop the operation when the desired position is reached.



Lowering The Blind Down:

1. Press the DOWN button to lower the blind.
2. Press the MY button to stop the operation when the desired position is reached.



Further Programming:

* When programming the different aspects of the will be required to jog to confirm en programmed, if the blind does not jog, press the program button on the motor (as detailed in page 2) briefly until the blind jogs once.

Setting Slat Tilt Up Limit (Up Slat Position):

1. Press the UP button. Blind will tilt to the pre-set UP limit.
2. Once the blind stops at the pre-set upper limit, press and hold the UP and DOWN buttons simultaneously until the blind jogs.
3. Press and hold either the UP or DOWN button to adjust slats to the new position.
4. Press and hold the MY (Stop) button until the blind jogs. New Upper Limit (Up Stop Position) is now added to the memory.

Setting Slat Tilt Down Limit (Down Slat Position):

1. Press the DOWN button. Blind will tilt to the pre-set DOWN limit.
2. Once the blind stops at the pre-set down limit, press and hold the UP and DOWN buttons simultaneously until the blind jogs.
3. Press and hold either the UP or DOWN button to adjust slats to the new position.
4. Press and hold the MY (Stop) button until the blind jogs. New Lower Limit (Down Stop Position) is now added to the memory.



Adjusting Blind Up Limit (Upper Blinds Position):

1. Press the UP button, to move the blind to the upper end limit.
2. Press and hold the UP and DOWN buttons simultaneously until the blind jogs.
3. Press and hold either the UP or DOWN button to adjust slats to the new position.
4. To confirm the new limit press and hold the MY button until the blind jogs.

Adjusting Blind Down Limit (Lower Blinds Position):

1. Press the DOWN button to move the blind to the lower end limit.
2. Press and hold the UP and DOWN buttons simultaneously until the blind jogs.
3. Press and hold the UP or DOWN button to move the blind to the new desired position.
4. To confirm the new limit press and hold the MY button until the blind jogs.

Adjusting the Speed - Increasing The Tilt Speed:

1. To increase the tilt speed, press the MY and UP buttons until the blind jogs.
2. There are 4 speed settings, so repeat step 1 as needed.
3. The maximum setting has been reached when the motorised product briefly moves 3 times in one direction then 3 times in the other direction.

Adjusting the Speed - Decreasing The Tilt Speed:

1. To reduce the tilt speed, press the MY and DOWN buttons until the blind jogs.
2. There are 4 speed settings so repeat step 1 as needed.
3. The minimum setting has been reached when the motorised product briefly moves 3 times in one direction then 3 times in the other direction.

Note: Tilt & Lift motor has 4 speed settings, each action increases speed by 1. When upper speed has been reached, blind will no longer respond

Deleting A Remote:

1. Using a paper clip or pen, press and hold the PROGRAM button on the original remote until the blind jogs once.
2. Using a paper clip or pen, press and hold the PROGRAM button on the second remote until the blind jogs once. Second remote is now deleted and will not operate the blind.

Restore To Factory Settings:

To delete all previous settings: Using a paper clip, press and hold the PROGRAM button, located on the top of the motor casing, until the blind jogs 3 times (approx. 12 seconds)

Note: All remotes and limits will be erased from the motor memory.

