

Vertical Blind Fitting Instructions:

Top Fixing:

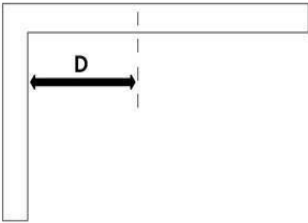

Step 1:

Measure and mark the distance (D), allowing for obstructions like handles that protrude into the recess area. Position brackets approx. 5cm from the ends of where the headrail is to be positioned. If more than 2 brackets are supplied, fit the additional brackets at equal spacing across the length of the blind. Please ensure fixings are suitable for the wall/surface to which you are mounting the brackets.

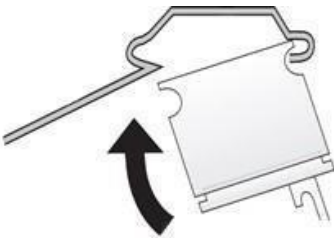

Step 2:

Tilt and hook headrail into bracket at point (E). Rotate the headrail into position until it clicks. To release the headrail, push the bracket at point (F).

Face Fixing:

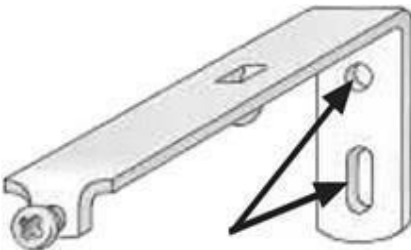

Step 1:

Position brackets approx. 5cm from the ends of where the headrail is to be positioned. If more than 2 brackets are supplied fit the additional brackets at equal spacing across the length of the blind. Please ensure fixings are suitable for the wall/surface to which you are mounting the brackets.

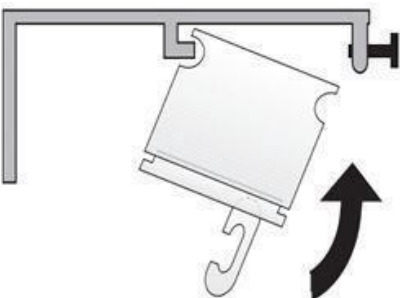

Step 2:

Hook the back of the headrail into the bracket and rotate the headrail into position. Secure headrail by tightening the short screw in the front of the bracket.

Step 3:

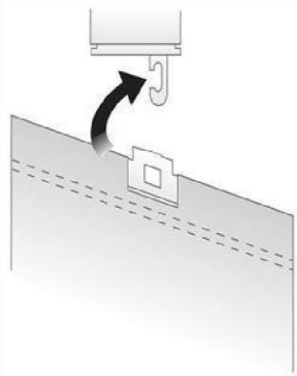

With the headrail in place, use the beaded chain to turn the hooks so that they are all facing in the open position (making it easier to hook the slats on) and then hook each slat on to each of the hooks on the headrail. Slide the weights in to the bottom of the slats and then clip the bottom chain down the front and back of the slats. Any excess chain can be cut away.

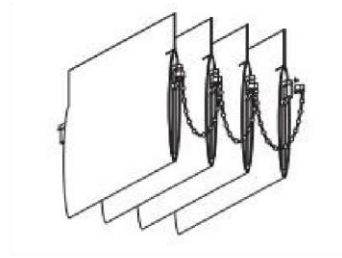
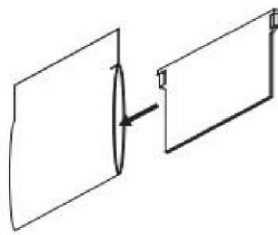

WARNING

Young children can be strangled by loops in pull cords, chains, tapes and inner cords that operate the product. Always use a safety device to keep cords or chains out of reach of children.

To avoid strangulation and entanglement, keep cords out of the reach of young children. Cords may become wrapped around a child's neck. Move beds, cots and furniture away from window covering cords.

Do not tie cords together. Make sure cords do not twist and create a loop.

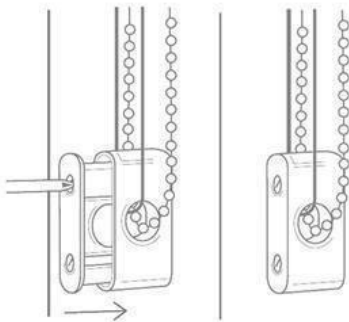

SAFETY DEVICE

The safety device must be installed at the maximum distance possible from the control mechanism to prevent looped chain becoming slack.

Place the safety device on the wall and mark the positioning of the 2 screw holes.

Drill holes using a suitable drill bit.

Place device into position ensuring the chain is fully taut.

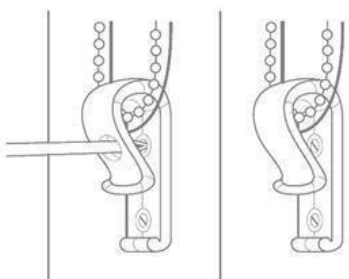

RETAINING DEVICE

Screw the retaining device using suitable fixings ensuring the device is fully closed.

(If your blind is supplied with our child safe draw rod control option, there is no requirement to fit an additional child safety device)